

REV.	DESCRIPTION	DATE
-	initial release	3/6/15

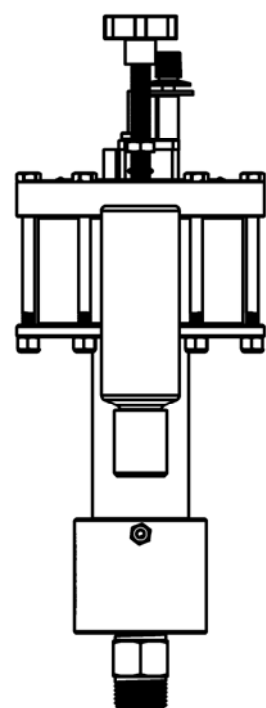
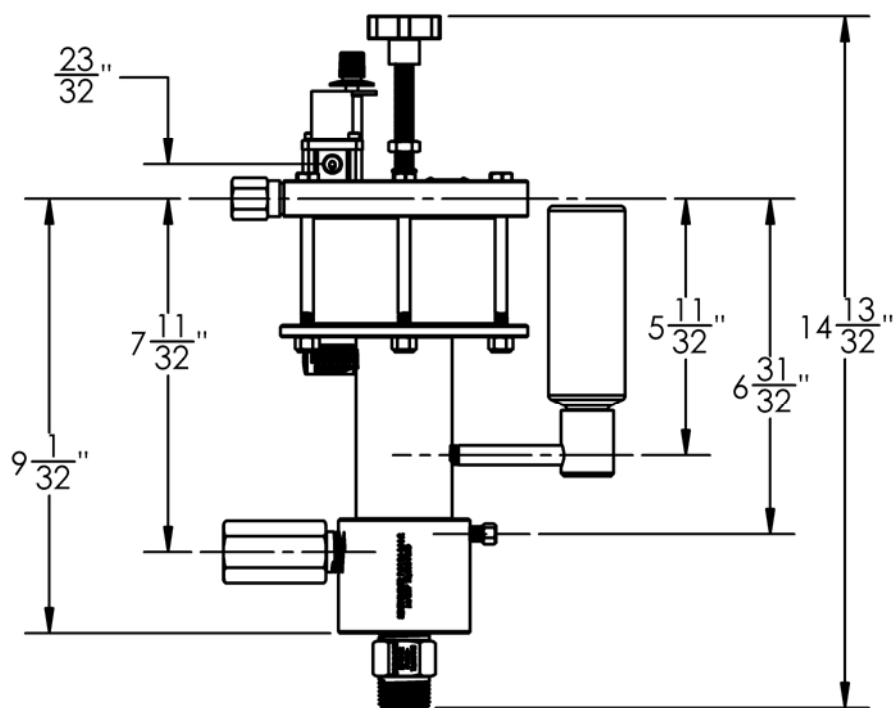
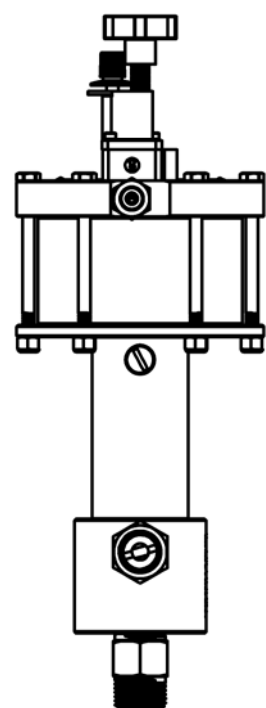
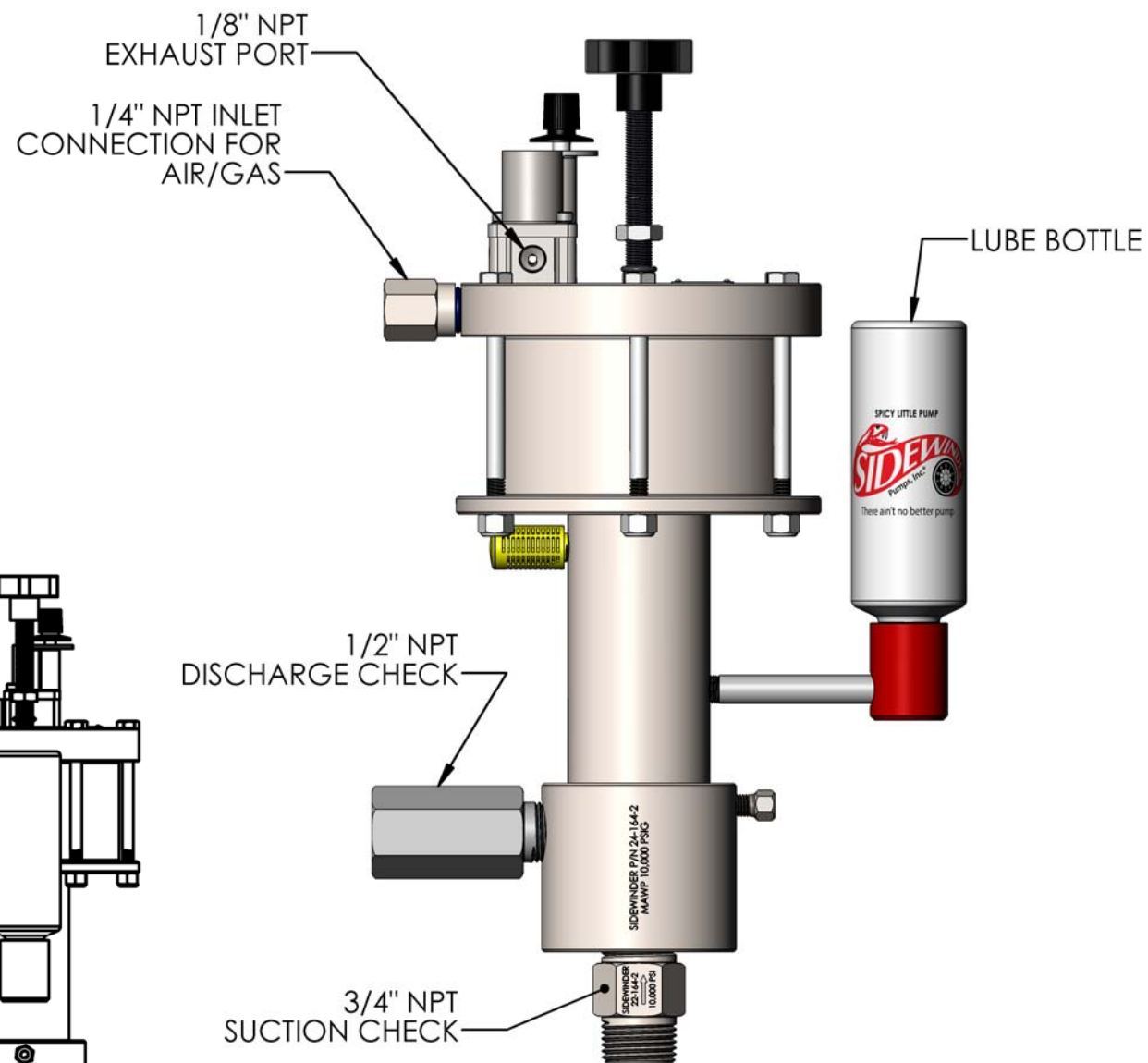
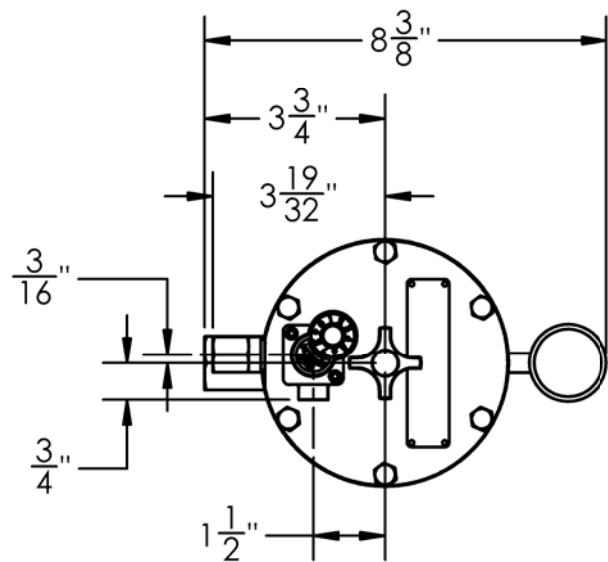

UNLESS NOTED OTHERWISE, DIMENSIONS ARE IN INCHES, AND TOLERANCES ARE AS FOLLOWS:

FRACTIONAL:  $\pm 1/32$   
 ANGULAR:  $\pm 1/2^\circ$   
 MATERIAL FINISH: 125  
 TOTAL RUNOUT WITHIN .010 TIR/FIM

ONE PLACE DECIMAL .x  $\pm .015$   
 TWO PLACE DECIMAL .xx  $\pm .010$   
 THREE PLACE DECIMAL .xxx  $\pm .005$

FOR DRILLED HOLES:  
 UP TO 1/2" +.005/-0.001  
 OVER 1/2" TO 1" +.010/-0.001  
 OVER 1" TO 2" +.015/-0.001

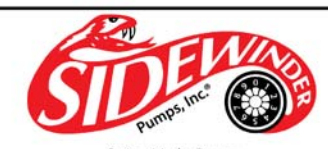

Spicy Little Pump  
 PO BOX 80769  
 107 COMMISSION BLVD  
 LAFAYETTE, LA 70598-0769

PART NAME:  
**MODEL 164 "C"**  
 OVERALL ASSEMBLY

**PROPRIETARY AND CONFIDENTIAL**  
 THE INFORMATION CONTAINED IN THIS DRAWING IS THE SOLE PROPERTY OF SIDEWINDER PUMPS, INC. ANY REPRODUCTION IN PART OR AS A WHOLE WITHOUT THE WRITTEN PERMISSION OF SIDEWINDER PUMPS, INC. IS PROHIBITED.

DRAWN BY:	PRS	3/11/2014	SIZE	PART NO.	REV
CHECKED BY:	WPG	3/11/2014	B	<b>MODEL 164 "C"</b>	-
MATERIAL: SEE NOTES			DO NOT SCALE DRAWING SHEET 1 OF 1		

SIZE	PART NO.	REV
B	<b>MODEL 164 "C"</b>	-